

DAMMON
ENGINEERING, INC.

CHIEF ENGINEER
EMMETT
DAMMON, P.E.

CHIEF ARCHITECT
ROBERT
WILTSE

554 OLD SPANISH TRAIL
SLIDELL, LA. 70458
OFFICE: 985-649-5632
FAX: 985-641-5950

WEBSITE:
WWW.DAMMONENGINEERING.COM
EMAIL:
DAMMONENR@BELL.SOUTHWEST.NET

ARCHITECTURE
ENGINEERING
STUDIES
PLANNING
INVESTIGATION
EXPERT WITNESSES

SLIDELL
ATHLETIC CLUB

BOB THIRSTRUP
OAK SAC PROPERTY, LLC
OAK HARBOR BLVD.
SLIDELL, LA
70458

FLOOR
PLAN

REV:

SCALE: AS NOTED

JOB#: 2121

DATE: 06-22-11

SHEET

A-1

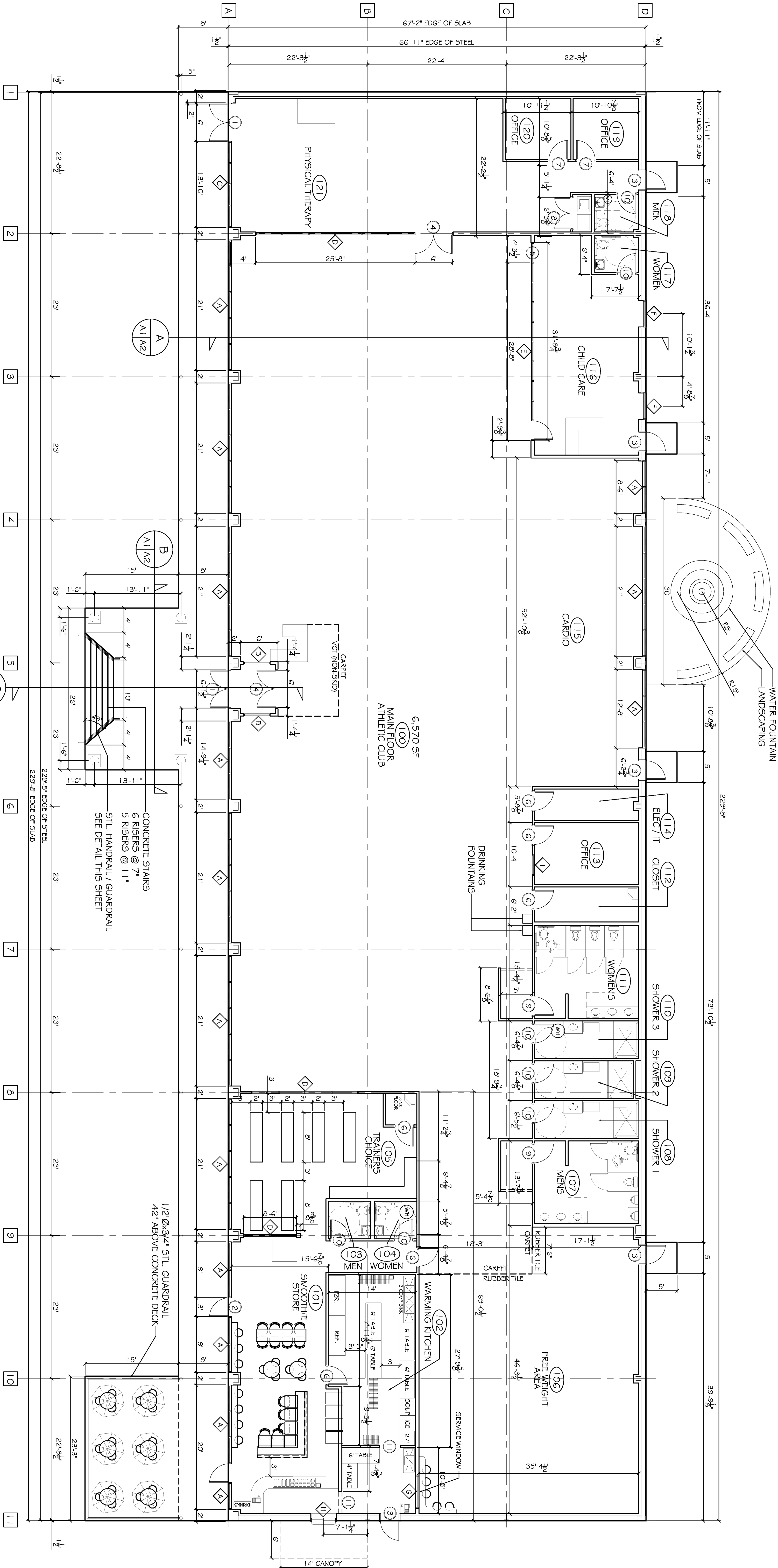

FLOOR PLAN

SCALE: 1/8" = 1'-0"

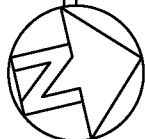

- GENERAL NOTES**
1. INSULATION AND INSULATION ASSEMBLIES SHALL MEET THE REQUIREMENTS OF SECTION 7.19.
 - A. CONCEALED INSULATION SHALL HAVE A FLAME SPREAD OF 0-25 AND SMOKE DEVELOPED INDEX OF 0-450. EXCEPT THAT IN COMBUSTIBLE (WOOD FRAME) CONSTRUCTION.
 - B. FACING SHALL COMPLY WITH IBC 2009.
 2. PROVIDE 5"x5" LANDINGS, LEVEL WITH FINISHED FLOOR, OUTSIDE EXTERIOR DOORS ON WEST SIDE OF BUILDING. THRESHOLDS SHALL BE NOT MORE THAN 1/2" IN HEIGHT AND SHALL BE BEVELED IF MORE THAN 1/4".
 3. CONTRACTOR TO VERIFY ALL SITE CONDITIONS, BUILDING LOCATIONS, AND DIMENSIONS PRIOR TO CONSTRUCTION.
 4. MATERIALS SHALL BE NEW AND U.L. LISTED.
 5. NO WORK SHALL BE CONCEALED UNTIL APPROVED BY LOCAL INSPECTORS.
 6. CONSTRUCTION SHALL COMPLY WITH ALL PARISH, STATE, AND LOCAL CODES.
 7. CONTRACTOR SHALL GUARANTEE WORK FOR ONE YEAR.
 8. CONTRACTOR SHALL FURNISH WATER AND POWER FROM EXISTING SOURCES.
 9. EXTERIOR CAULKING SHALL BE THICKAL CAULK.
 10. PAINT GRADE TO SHALL BE SHERWIN WILLIAMS OR EQUIVALENT. ALL WORK TO RECEIVE 3 COATS. COLOR SELECTION BY OWNER.
 11. PROVIDE CLEANUP ON A REGULAR BASIS. NO TRASH STORED IN BUILDING.
 12. ALL BATT INSULATION SHALL HAVE A CLASS "A" (0-25) FLAME SPREAD IN COMPLIANCE WITH APPLICABLE CODE.
 13. USE 6" STUDS, OR 4" STAGGERED STUDS AT ALL PLUMBING WALLS.
 14. PROVIDE GALVANIZED METAL PAN WITH DRAIN AT WATER HEATER LOCATION.
 15. ALL CORNERS SHALL BE PROPERLY BRACED FOR WIND LOADS. A 48" SHEATHING SHALL BE PROVIDED EVERY 20 FEET OF WALL LENGTH.
 16. INTERIOR LOCKS ON DOORS IN MEANS OF EGRESS SHALL NOT REQUIRE THE USE OF A KEY. SPECIAL KNOWLEDGE, OR SPECIAL DEVICE TO OPEN IN THE DIRECTION OF EGRESS. ALL DOORS SHALL HAVE LEVER TYPE HANDLES.
 17. INTERIOR WALLS AND CEILINGS SHALL HAVE A FLAME SPREAD OF 0-200 AND A SMOKE DEVELOPMENT RATING OF 0-450.
 18. ALL WORK SHALL COMPLY WITH THE LATEST EDITION OF ALL LOCAL, STATE, AND NATIONAL CODES COVERING THE TYPE OF WORK BEING PERFORMED.
 19. PROVIDE PORTABLE FIRE EXTINGUISHERS IN ACCORDANCE WITH NFPA 101. SEE APPENDIX "E" OF NFPA 101 FOR DISTRIBUTION OF EXTINGUISHERS.
 20. ALL FIRE WALLS SHALL EXTEND TIGHT TO ROOF DECK AND BE SEALED WITH AN APPROVED FIRE CAULK.
 21. ALL ELECTRICAL, MECHANICAL, AND PLUMBING MATERIALS PENETRATING FIRE WALLS SHALL BE FIRE CAULKED. (PENETRATIONS THROUGH RATED CONSTRUCTION SHALL BE SEALED WITH A MATERIAL CAPABLE OF PREVENTING THE PASSAGE OF FLAMES AND HOT GASES WHEN TESTED IN ACCORDANCE WITH ASTM-E814.)
 22. SERVICE COUNTER SHALL HAVE A HCP ACCESSIBLE WRITING SURFACE. MAX. 36" FROM F.F. (ADAAG MANUAL, 1998, PG. 135)

AREA BY USE:
TOTAL AREA: 15,000 SQ. FT.
PHYSICAL THERAPY: 1,500 SQ. FT. (1,050 NET)
CHILD CARE: 600 SQ. FT. (540 NET)
SMOOTHIE STORE: 2,040 SQ. FT.
ATHLETIC CLUB: 11,360 SQ. FT. (9,400 NET)

PLUMBING FEATURE COUNT:
PER LA STATE PLUMBING CODE 2000 EDITION
BUILDING GROSS SQ. FT. = 15,500
BUILDING NET SQ. FT. = 12,535
OCCUPANT LOAD FOR CLUB OCCUPANCY = 30 SQ. FT. PER 1 OCC.
LOAD = 12,535/30 = 418 OCCUPANTS
MENS TOILETS REQUIRED = 5
FEMALE TOILETS REQUIRED = 6
FEMALE TOILETS PROVIDED = 6

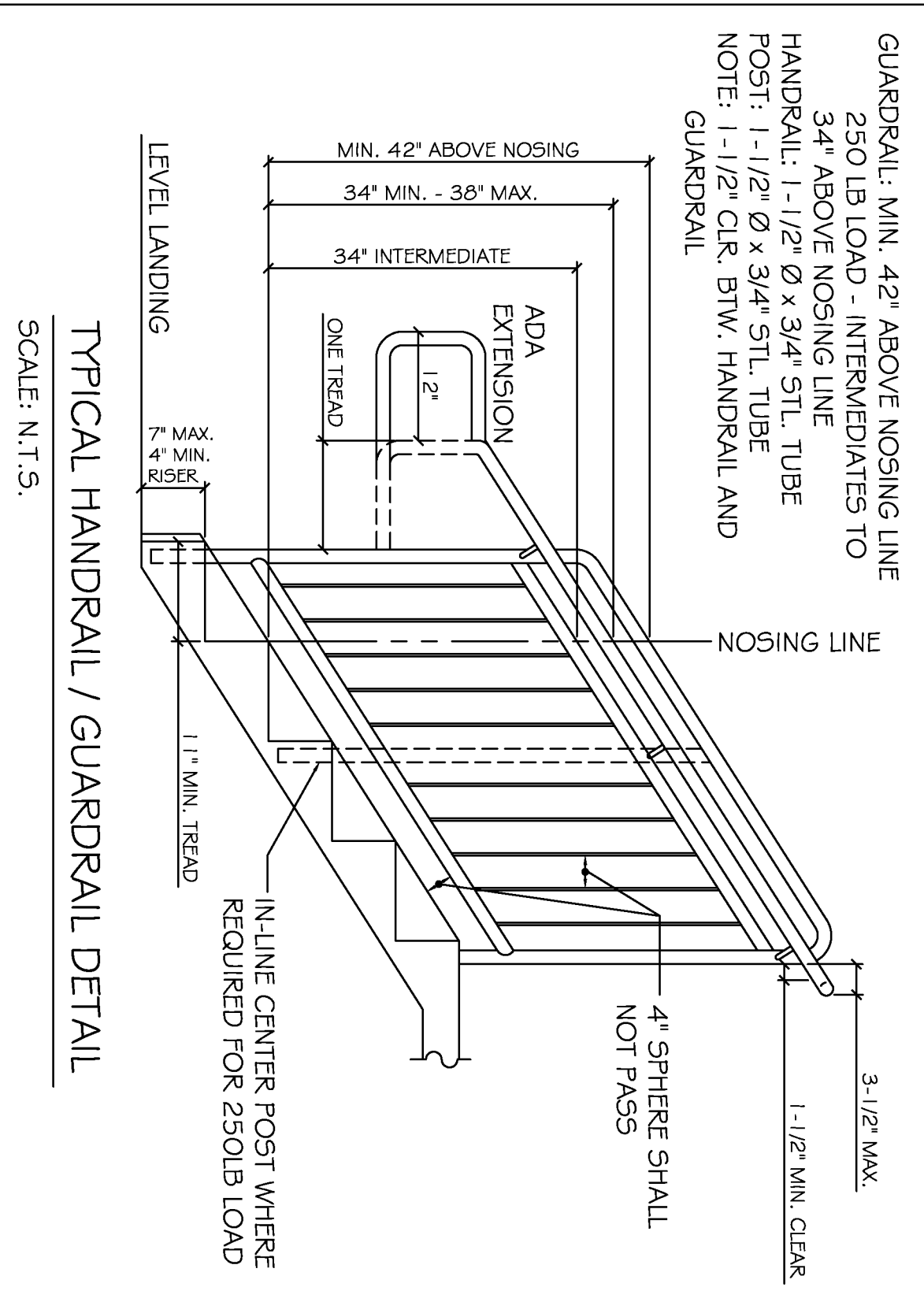

TYPICAL HANDRAIL / GUARDRAIL DETAIL

SCALE: N.T.S.